



# USER AND MAINTENANCE MANUAL SERIES **PUMA**

# TABLE OF CONTENTS:

## 1. INFORMATIVE SECTION

1.1	Foreword.....	5
1.2	Main parts .....	8
1.3	Optional parts.....	9
1.4	Manufacturer's identification data.....	9
1.5	Identification plate.....	9
1.6	Permitted Uses .....	9
1.7	Authorised environmental conditions .....	9
1.8	Noise level.....	10
1.9	Technical data .....	11
1.9	Warranty.....	13

## 2. SAFETY SECTION

2.1	Safety Information.....	14
2.2	Safety recommendations.....	15
2.3	Safety plates and symbols .....	17
2.4	Residual risks.....	18
2.5	Applied Directives.....	19

## 3. HANDLING, UNPACKING AND INSTALLATION SECTION

3.1	Handling.....	20
3.2	Unpacking .....	21
3.3	Installation.....	23

## 4. OPERATION SECTION

4.1	Description of the controls .....	25
4.2	Operating cycle.....	27
4.3	Cleaning the filter .....	29
4.4	Emptying the refuse container .....	30
4.5	Inserting and locking the dirt container .....	31
4.6	Storage - decommissioning .....	32

## 5. MAINTENANCE SECTION

5.1	Informative notes .....	33
5.2	General safety regulations .....	34
5.3	Replacing the filter .....	36
5.4	Replacing the filter cartridges on the C.C.A. cleaning system (if provided) .	38
5.5	Replacing the H filter (if provided).....	40
5.6	Troubleshooting .....	42
5.7	Scrapping .....	43



## 1. INFORMATIVE SECTION



This manual forms an integral part of the vacuum cleaner. Read this manual and the other attachments supplied carefully. Knowledge of the instructions here contained is indispensable for the safe use and maintenance of the vacuum cleaner

**IMPORTANT** - The DEPURECO term and logo in this document refer to and are the property of **DEPURECO INDUSTRIAL VACUUMS S.r.l.**

This document remains the exclusive property of DEPURECO S.r.l. Full or partial reproduction by any means (graphical, electronic, etc.) is prohibited without prior authorisation from the Company Management.

### 1.1 Foreword

Dear Customer

Thank you for having chosen DEPURECO; we hope you will enjoy using your new DEPURECO series TX vacuum cleaner

This manual has been drafted in order for our customer to fully appreciate the quality of this machine.

Please read all sections before using the machine for the first time.

It includes information, recommendations and important warnings concerning the use of the vacuum, which will help fully exploit the technical properties of your machine.

Read messages, warnings and indications preceded by the following symbols carefully:



For the safety of persons



For the integrity of the vacuum cleaner



For the safeguard of the environment

This vacuum cleaner has been designed for the suction of dust and processing residues.



The material vacuumed by gravity tends to settle on the container bottom; the finest dust particles contained in the mixture will settle on the filtering surface, inside the filter chamber.

This manual describes the following models:

## PUMA

The vacuum cleaner is equipped with the following filters:

- ☐ M FILTER (P11718)
- ☐ TEFLON-COATED M FILTER (P11719)
- ☐ ANTISTATIC M FILTER (P11847)
- ☐ NOMEX FILTER (P11840)
- ☐ H FILTER CARTRIDGE (if provided) (P09868)
- ☐ CARTRIDGE FOR THE C.C.A. CLEANING SYSTEM (if provided) (P09577)

This manual provides all pieces of information necessary for the use and maintenance of the vacuum cleaner.

This specific model has undergone strict testing to ensure maximum reliability. Its operation and durability will depend on proper use and maintenance.

This manual forms an integral part of the vacuum cleaner and must accompany the machine for its entire life cycle.

In the event it is lost or damaged, you can request another copy from DEPURECO INDUSTRIAL VACUUMS S.r.l. (henceforth shortened to DEPURECO).

The technical information contained in this manual is exclusive property of DEPURECO and must be considered confidential.

Reproduction, even partial, of graphics, text and illustrations is prohibited by law.

Some details shown in the figures in this manual may differ from those on your vacuum; this is because some components can be removed to ensure maximum illustration clarity.

This manual has been divided into sections for easy consultation and each section has been identified by a specific graphical symbol.

The topics covered in this manual are those expressly required by Machinery Directive 2006/42/EC and the technical data are taken from the technical file archived at DEPURECO.

With reference to Regulation 1907/2006/EC (REACH), DEPURECO hereby declares that no Substances of Very High Concern - (SVHC) included in the Candidate List, are contained in its products.

This manual should be kept in a place accessible to all personnel in charge with operating and performing maintenance on the vacuum cleaner.

In the event of any dispute arising, the Court of Turin (Italy) shall have jurisdiction



This manual forms an integral part of the vacuum cleaner. Read this manual and the other attachments supplied carefully. Knowledge of the instructions here contained is indispensable for the safe use and maintenance of the vacuum cleaner

## 1.2 Main parts



### PUMA 30 e PUMA 35

### PUMA (tutti i modelli esclusi PUMA 30 e 35)

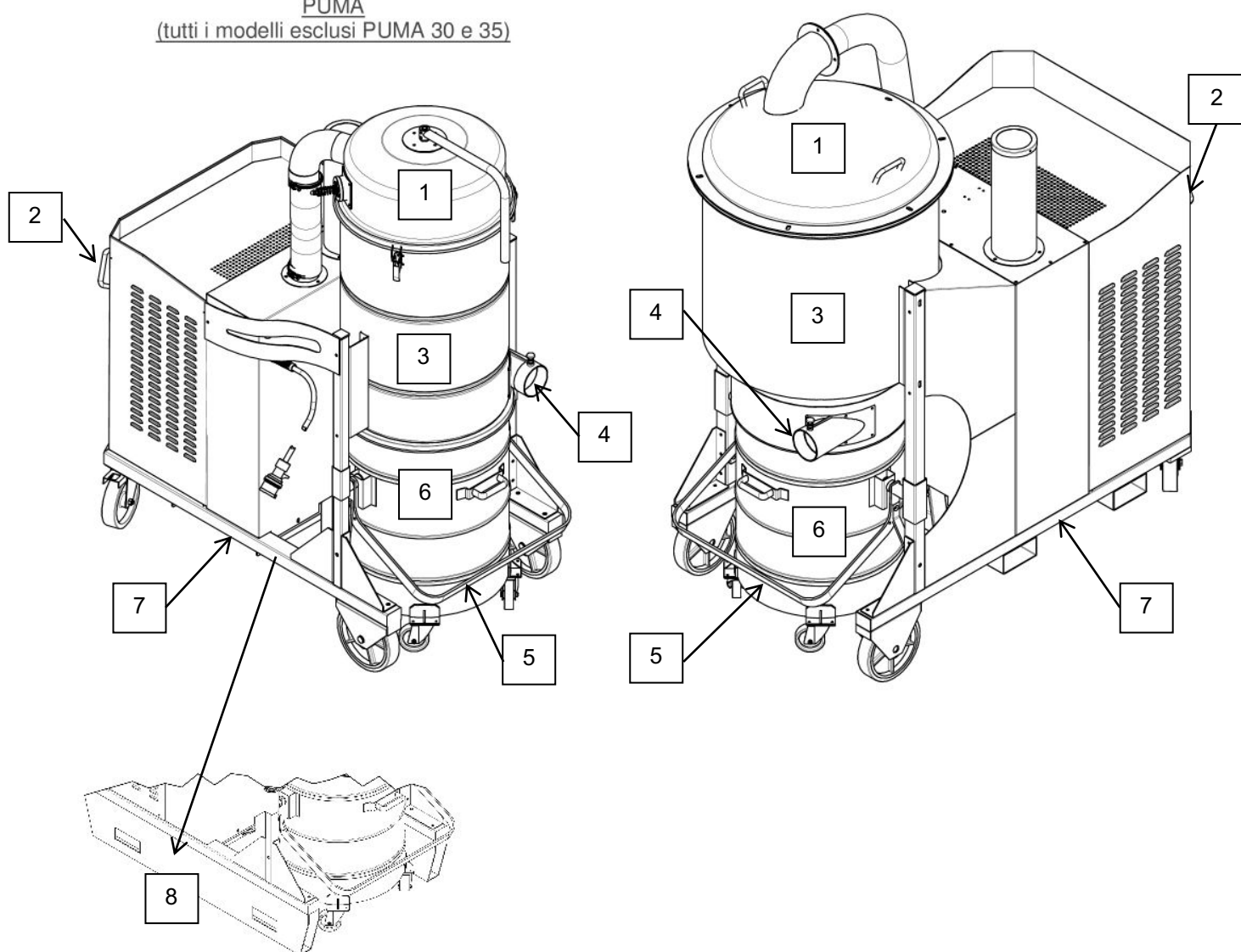

1. Vacuum cleaner head
2. Handles to move the product
3. Filter chamber
4. Suction nozzle
5. Container release handle
6. Dirt collection container
7. Puma frame with wheels
8. Frame with "FIX" base (where applicable)



### 1.3 Optional parts

DEPURECO provides a wide range of optional accessories, depending on the application of the vacuum cleaner.

### 1.4 Manufacturer's identification data

#### **DEPURECO INDUSTRIAL VACUUMS S.r.l.**

Corso Europa 609 - 10088 Volpiano (TO) - ITALY

**phone** +39 011 98 59 117 - **fax** +39 011 98 59 326 | VAT NO. 02258610357

e-mail: [depureco@depureco.com](mailto:depureco@depureco.com) - website: [www.depureco.com](http://www.depureco.com)

### 1.5 Identification plate

The data on the vacuum identification plate must be referred to in any correspondence with the manufacturer or the dealer.

<b>DEPURECO S.r.l.</b>			Corso Europa 609 - 10088 Volpiano (TO) - ITALIA tel. +39 011 98 59 117 - fax +39 011 98 59 326 MADE IN ITALY	
Mod.		Volt		
Serial N°	kW	Amp	Hz	
Dust class	IP	Kg	Year	

### 1.6 Permitted Uses

This model of vacuum cleaner has been designed, built and protected for exclusively for the professional industrial use of suctioning non-flammable and non-harmful dry and/or wet dust and shavings.

Any other use is considered **IMPROPER**.

### 1.7 Authorised environmental conditions

To ensure correct operation, the vacuum cleaner must be kept away from atmospheric agents (rain, hail, snow, fog, dust in suspension, etc.) in an area with a room temperature range between 5° and 45°C and a relative humidity no higher than 70%.

The work environment must be clean, suitably lit and must not give rise to potentially explosive atmosphere.





## 1.8 Noise level

The phonometric tests performed on this specific vacuum cleaner model demonstrate a sound pressure level of

PUMA 10  
PUMA 12  
PUMA 15 P  
PUMA 15 S  
PUMA 18  
PUMA 20

74 dB(A)

PUMA 30 P  
PUMA 30 S  
PUMA 35 P  
PUMA 35 S

78 dB(A)



### **WARNING!**

Workers exposed to sound pressure levels higher than 85 dB(A) must be protected by suitable personal protection device (PPE) such as certified ear muffs.



**Under these conditions, workers must be provided with adequate training and information on risks arising from noise exposure.**



## 1.9 Technical data

	U.M.	PUMA 10	PUMA 12	PUMA 15P	PUMA 15S	PUMA 18
Weight*	[Kg]	310	340	350		370
Weight with FIX base*	[Kg]	340	-	-	390	-
Overall dimensions**	[mm]	850 x 1550 x 1980				
Voltage / Frequency	[V] - [Hz]	400 - 50/60				
Power	[kW - HP]	7.5 - 10	8.5 - 12	11 - 15		12.5 - 18
Maximum negative pressure	[mBar]	310	420	350	480	420
Continuous negative pressure	[mBar]	270	200	250	440	290
Air flow rate	[m <sup>3</sup> /h]	730	1050	1120	550	1120
M filter surface	[m <sup>2</sup> ]	4.5				
SP cartridge surface (where applicable)	[m <sup>2</sup> ]	12				
H filter surface (where applicable)	[m <sup>2</sup> ]	11				
Noise level	[dB-A]	74				
Container capacity	[L]	175				



	U.M.	PUMA 20	PUMA 30 P	PUMA 30 S	PUMA 35 P	PUMA 35 P
Weight*	[Kg]	-	600		760	
Weight with FIX base*	[Kg]	420	-			
Overall dimensions**	[mm]	850 x 1590 x 1930	1050 x 1950 x 2300			
Voltage / Frequency	[V] - [Hz]	400 -50/60				
Power	[kW - HP]	15 - 20	20 - 28		25 - 34	
Maximum negative pressure	[mBar]	410	320	600	450	550
Continuous negative pressure	[mBar]	350	250	460	320	445
Air flow rate	[m³/h]	1050	1980	1100	2100	1130
M filter surface	[m²]	-	11			
SP cartridge surface (where applicable)	[m²]	12	18			
H filter surface (where applicable)	[m²]	11				
Noise level	[dB-A]	74	78			
Container capacity	[L]	175				

(\*) weight without packaging, packaging weight = 18 Kg

(\*\*) overall dimensions without packaging



## 1.9 Warranty

DEPURECO guarantees this model of vacuum cleaner for a period of 12 months from the date of purchase, indicated on the receipt at the time of delivery of the product.

The guarantee is null and void in the event that the vacuum is repaired by unauthorised third parties or by using equipment, accessories or components not supplied or not authorised by DEPURECO, or if the serial number is removed (during the guarantee period).

For the duration of the guarantee, DEPURECO undertakes to repair or replace free of charge parts and components which prove to have manufacturing defects.

Repairs will be exclusively executed at a DEPURECO site or in a DEPURECO approved Assistance Centre and the machine must be sent free of charge (freight cost at user's charge unless otherwise agreed).

The guarantee does not cover cleaning of working parts.

The purchase invoice must be shown to the authorised technical personnel carrying out the repair and must accompany the vacuum during its shipment.

Defects that are not evidently due to materials or manufacturing will be examined solely at our premises or at a Technical Service Centre of our choosing.

Should the complaint be unjustified, all repair and/or replacement expenses shall be charged to the purchaser.

In any case, the following items are not covered by the guarantee: accidental damage due to transport, negligence, abnormal use, improper use, non-compliance with the instructions contained in this booklet or arising from phenomena that do not depend on normal use/operation of the vacuum.

DEPURECO shall not be held liable for any injuries to persons or damage to objects caused by misuse or improper use of the vacuum.

In the event of any dispute arising, the Court of Turin (Italy) shall have jurisdiction.



To use the warranty visit [www.depureco.com](http://www.depureco.com) or photocopy the form available on the last page of this manual, fill it in all its parts (in capital letters would be recommended), and send it via fax to Depureco at the number + 39 011 98 59 117



**In the event of doubts, avoid interpreting the information! Call immediately your reseller!**



## 2. SAFETY SECTION

### 2.1 Safety Information



As per Italian Legislative Decree 81/08 and subsequent modifications, the Safety Manager must train and inform workers about risks involved with using the vacuum cleaner so that they may be able to avoid injury to themselves and others.

Failure to comply norms, laws or basic safety precautions, may cause accidents during operation, maintenance and repair of the vacuum cleaner. Accidents can frequently be avoided by recognising potentially hazardous situations before they occur. Adequate training is crucial to this end.

DEPURECO shall not be held liable for accidents or damage due to the improper use of the vacuum by untrained personnel or to failure to comply, even partially, with the occupational safety standards and intervention procedures contained in this manual.

Safety warnings and precautions are indicated in this manual as well as on the product itself. Operators must pay special attention to these hazard warnings to prevent accidents with serious consequences for themselves and other people.

The safety warnings are indicated by the following symbols:



**WARNING!**

Failure to comply with these warnings can cause injuries to the operator.



**WARNING!**

Failure to comply with these warnings can cause damage to the vacuum cleaner.



**WARNING!** Failure to comply with these warnings can harm the environment

DEPURECO designs and manufactures its equipment and accessories with care, identifying and compensating possible risks related to their use. In the event of equipment, procedures, work methods or techniques not expressly provided for by DEPURECO being used, it is crucial to ensure beforehand that there are no dangers for oneself and the others. Nevertheless, DEPURECO shall not be held liable.



**Use exclusively Depureco original spare parts.**

Depureco disclaims any liability in case spare parts other than original have been used.

## 2.2 Safety recommendations



### **WARNING!**

The following information is essential in view of preventing all hazards that may occur while the vacuum cleaner is running. However, they cannot replace the expertise and common sense of operators as an overall framework for the prevention of accidents.

Each section lists further safety measures specific to the various functions.

# CAUTION!

- This vacuum may only be used by suitably trained adults.
- This vacuum cleaner is intended for industrial use, e.g. in factories, warehouses, workshops.
- Ensure that mains electrical connects have suitable earthing.
- During use, always block the vacuum cleaner using the special brake located on the swivelling wheel
- This vacuum cleaner is not intended for corrosive or explosive environment.
- Keep the vacuum cleaner clear of foreign objects such as debris, oil, tools and other objects which may impede its functioning and cause personal injury.
- ether and alcohol for cleaning.
- Avoid prolonged contact with solvents and inhaling their vapours.
- Avoid using near open flames or heat sources; ensure adequate ventilation.
- Never use the vacuum cleaner without its filter.
- Do not vacuum lit cigarettes: the filter may catch fire.
- Do not vacuum petroleum products or inflammable liquids in general.



- 
- Ensure that all protection equipment and guards are in place and that all safety devices are present and operating.
  - Do not wear loose or flowing apparel such as ties, scarves, or torn clothing that could become hung or caught up by the vacuum cleaner.
  - Never open waste container while the vacuum cleaner is working.
  - Never use extension leads, plug-in connection devices and adapters.
  - Never use the vacuum cleaner on running machines
  - Do not climb on the vacuum cleaner.
  - Do not touch electrical wires, switches, buttons, etc. with wet hands.
  - Occasionally check the integrity of the power cable.
  - When using the industrial vacuum cleaner, some components (motor connector, motor body in particular) may reach high temperatures.
  - During operations to return to original work conditions, the personnel in charge must ensure at the end of the procedure that normal operating and safety conditions of the vacuum and, in particular, of the safety devices and protective guards involved in the operation are once again guaranteed.
- 
- Should the Customer install a tool not supplied by DEPURECO on the vacuum, the safety requirements of Machinery Directive 2006/42/EC must be met. Nevertheless DEPURECO shall not be held liable for problems caused by the use of such parts.
  - Structural damage, alterations or improper repairs can modify the protective capacity of the vacuum, thereby nullifying this certification and releasing DEPURECO from any liability.
  - This manual must be kept near the machine, so it may be consulted to check the correct cycle use at any time doubts may arise.
  - In the event it is lost or damaged, request another copy from DEPURECO.



**WARNING!**

**This vacuum cleaner could contain dust that may be hazardous to your health.  
The emptying out and maintenance procedures, including removing the dust containers, must be carried out exclusively by specialized personnel wearing suitable safety clothing.  
Never switch the machine on in the absence of a complete filtering system.**

## 2.3 Safety plates and symbols

Plates with safety symbols and/or messages are applied to the vacuum and its packaging. These pages show their precise location and the nature of the hazard.



**Warning!**

Ensure that all safety messages are perfectly legible.

Clean them using a cloth with water and soap. Do not use solvents, naphtha or petrol.

Request replacements for damaged plates from DEPURECO.

If a plate is located on a component that is being replaced, make sure to fit the old plate to the new component.

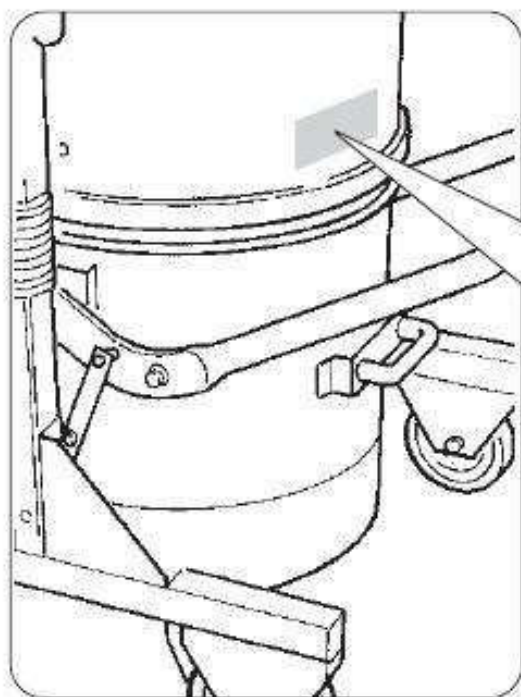

**Warning!**

Crushing hazard for the upper limbs during insertion and locking of the dirt container under the vacuum cleaner.

Never place your hands between the vacuum and the dirt container while inserting and locking the later under the vacuum cleaner.

Lock the container by means of the special lever, using BOTH HANDS



**Warning!**

Read carefully this use and maintenance manual before using the vacuum cleaner or carrying out maintenance operations on it





Read carefully the instructions on the packaging before handling the vacuum cleaner

## 2.4 Residual risks

DEPURECO recommends complying with the instructions, procedures and recommendations in this manual and with the safety standards in force. DEPURECO also recommends using suitable personal protective equipment as well as the protection devices integrated in the vacuum.

The residual risks analysed on the vacuum and/or its components could be:

### **Electrical risks during maintenance due to the requirement to work on live parts**

Pursuant to Italian Legislative Decree 81/08 – articles 80 to 87 – it is prohibited to operate on live parts, notwithstanding the exceptions set forth by said Legislative Decree.

### **Risks associated with incorrect use in presence of explosive and inflammable liquid substances**

The vacuum must not be used in environments containing liquid substances or liquids that can evaporate at room temperature, inflammable powders and gas.

### **Risks related to operation in humid environments**

Respect the limitations indicated in this manual, in section 1.5 “Authorised environmental conditions”.

### **Risk of incorrect interpretation of the safety pictograms**

With reference to risk analysis and identification, DEPURECO has installed hazard labels on the vacuum, in compliance with the standards concerning graphical symbols.

The user must immediately replace any safety plate rendered illegible due to wear or damage.



#### **Warning!**

The removal of safety plates from the vacuum and/or its components and packaging is strictly prohibited.

DEPURECO shall not be held liable for the vacuum's safety in the event of failure to comply with this prohibition.



---

## 2.5 Applied Directives

The following directives apply to the vacuum cleaner described in this manual:

- 2006/42/EC Machinery Directive
- 2014/30/EU Electromagnetic compatibility directive
- 2011/65/EU - ROHS - Directive on the restriction of the use of certain hazardous substances in electrical and electronic equipment

The reference standards, including their binding requirements, are managed within the DEPURECO Quality Management System



### 3 HANDLING, UNPACKING AND INSTALLATION SECTION

#### 3.1 Handling



**Warning!**

The instructions for transporting and unpacking the vacuum correctly are shown on the packaging as well.

The following instructions also indicate the operations to be undertaken should the vacuum need to be re-packed or unpacked after subsequent transportation.

Dimensions of packed vacuum cleaner:

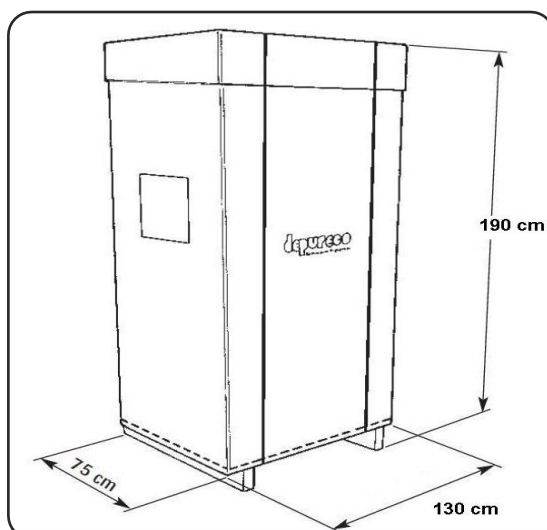

**The vacuum cleaner must be lifted and handled exclusively using a forklift having suitable load bearing capacity.**

When using a forklift, lift the load 200 mm off the ground and swing backwards.

Always keep the height of the working environment in mind when lifting loads.

Before starting any movement, ensure that the area is cleared and that there are no moving objects on the packaging. For lifting and handling, apply operating safety laws and normal instructions for fork-lift truck driving.

### 3.2 Unpacking

- Cut and unwind the two packaging fixing belts

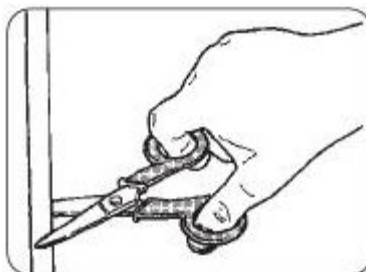

- remove the staples that fix the card packaging to the pallet with the aid of a screwdriver

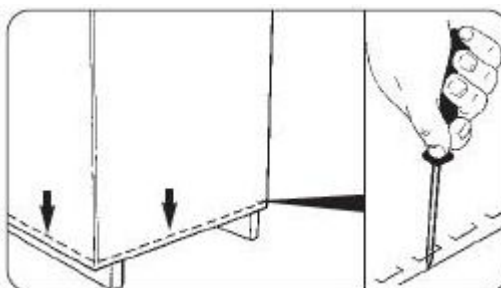

- remove the cardboard completely



Cut tapes between the platform and base of vacuum cleaner



The cardboard packaging can be recycled. To protect the environment, make sure to dispose it off in specialised collection centres.



**Warning!**  
Keep the pallet.  
In the event of subsequent transport, the vacuum must be secured to the pallet using the same fastening system.



### 3.3 Installation



#### Caution!

Before installing the vacuum, it is important to carry out a thorough preventive visual inspection to identify any damage which may have occurred during transport.

In the event of one or more components being damaged, do not continue with installation and inform DEPURECO about the anomaly and agree upon action to be taken.

The vacuum cleaner is already fitted with an appropriate filter intended exclusively to vacuum dry dust or debris

- Insert the hose equipped with a terminal in the special suction spout (detail no. 4, chap. 1.1) and make sure it has been securely attached to it
- insert the accessory desired for the type of suction from the opposite side of the tube

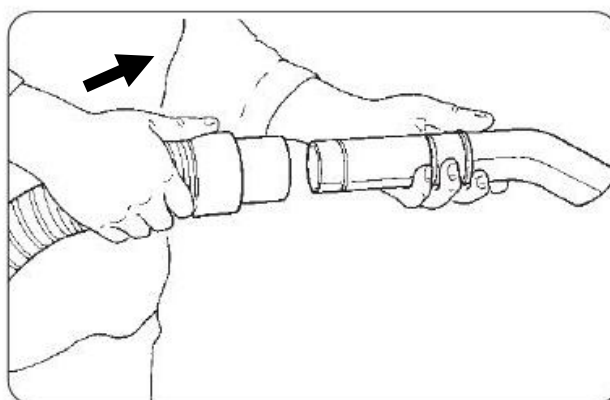

Note: the flexible tube and the relevant end-pieces and suction accessories are not included with the STANDARD model. Contact your dealer (or DEPURECO) for information regarding the various types of OPTIONALS that can be used on this specific model.

**The following operation must be carried out by a qualified electrician.**

Ensure that the power supply line corresponds to the voltage and frequency indicated on the identification plate and that it is efficiently earthed.

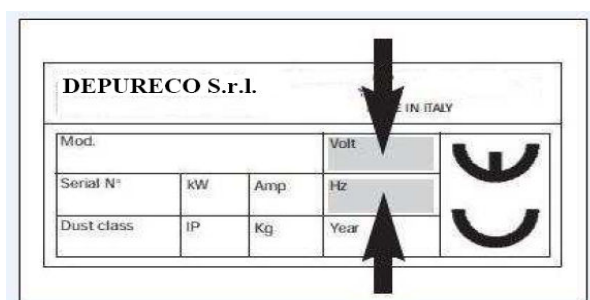



---

The vacuum cleaner's electrical current supply socket must be protected by a CE-marked circuit breaker.

Insert the plug (standard supply) into the socket.



**Warning!**

**Do not insert the plug in the power supply socket with wet hands.**

**Do not use extension leads.**



## 4 SEZIONE FUNZIONAMENTO

### 4.1 Description of the controls



#### Attention!

The vacuum cleaner can be used solely by authorised personnel after having read these use and maintenance instructions.

The user of the equipment and the maintenance technician, who carry out interventions



on the vacuum cleaner, must be adequately educated, informed and trained, in compliance with the occupational safety standards in force and, during the various operations, must wear personal protective equipment (PPE), such as safety footwear, gloves, protective goggles, mask, etc. The user must comply with the provisions in force concerning extracted materials and their disposal.

Electrical control panel for all Puma models (the position of the buttons may vary depending on the model)

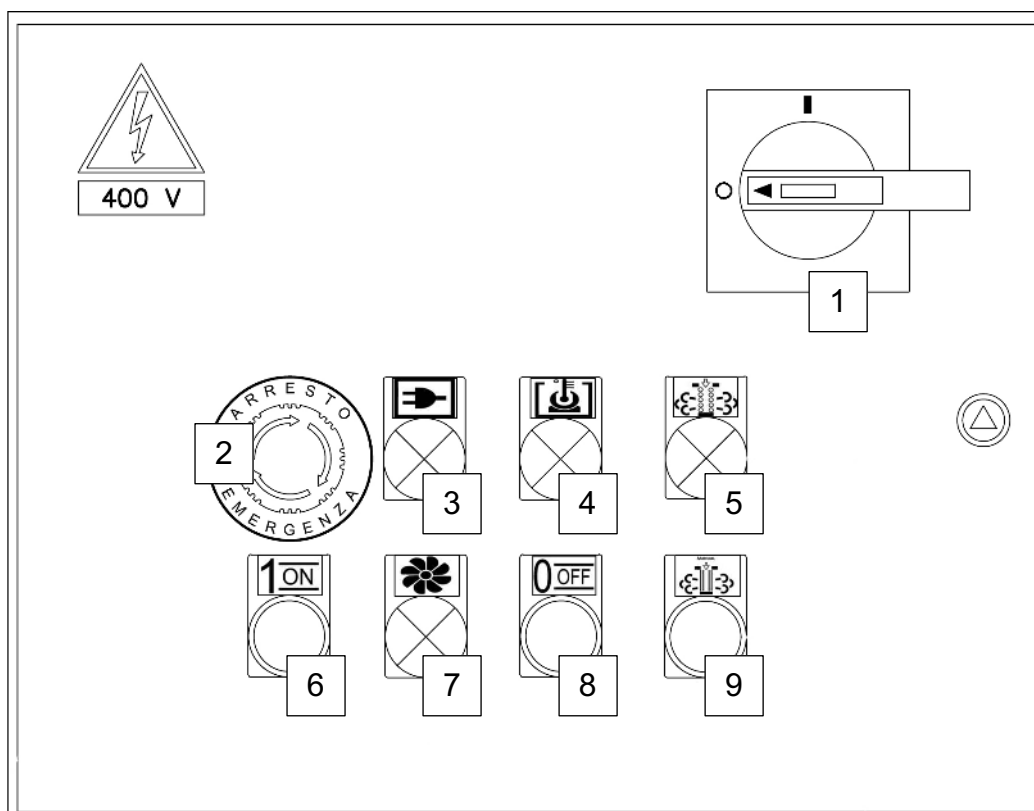



## Electrical control panel of Puma 20 with inverter (where applicable)

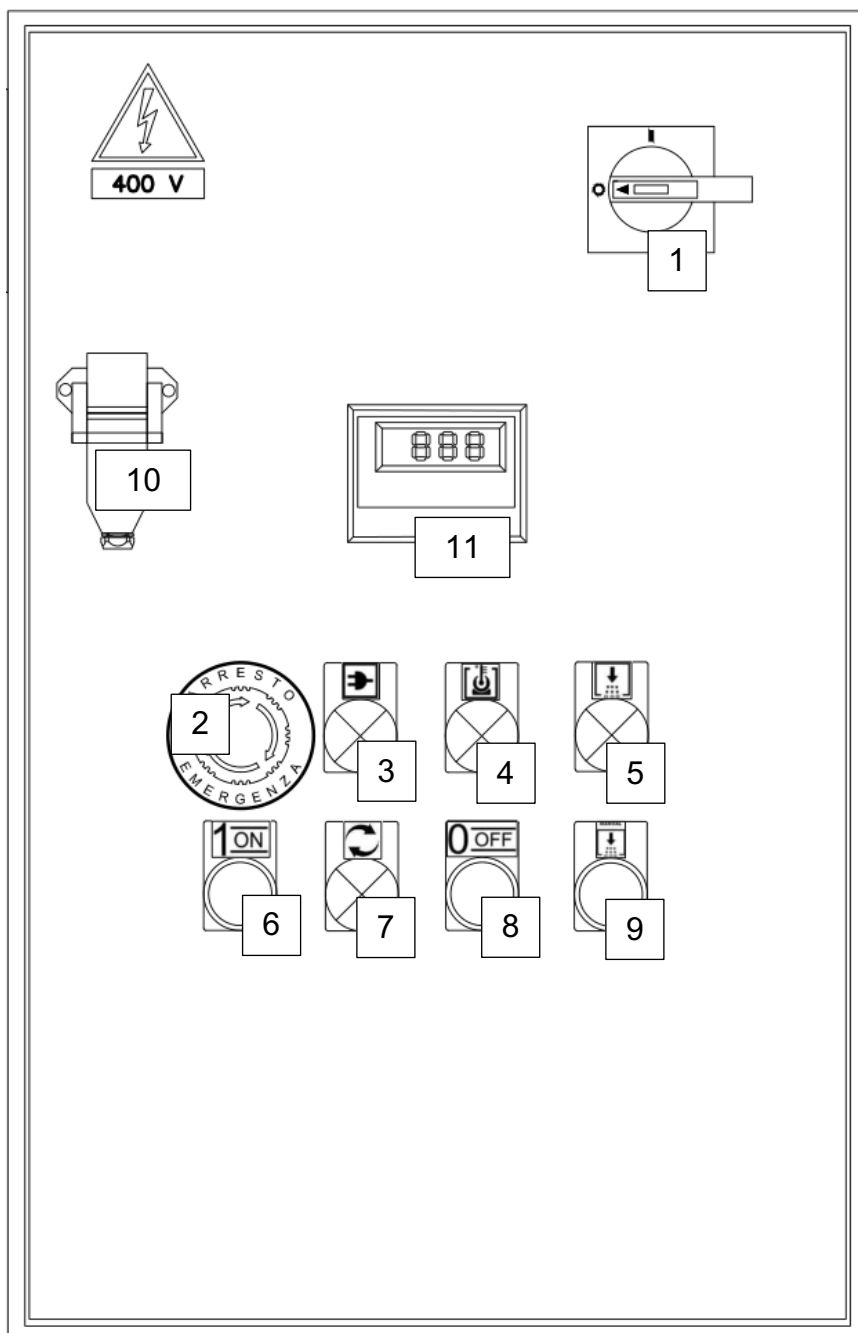

1. I/O switch
2. Red mushroom button: EMERGENCY STOP
3. White indicator light: VOLTAGE PRESENCE
4. Yellow indicator light: THERMAL CUT-OUT



5. Green indicator light: CLEANING FILTER IN PROGRESS (only on models with compressed air cleaning, pneumatic or electric filter shaker)
6. Green button: START SUCTION
7. Green indicator light: SUCTION IN PROGRESS
8. Red button: STOP SUCTION
9. Blue button: START MANUAL FILTER CLEANING (only on models with compressed air cleaning)
10. Plug for remote start (where applicable)
11. Panel for motor speed control (only on models equipped with inverter)

## 4.2 Operating cycle

Ensure that the power cord is intact and in perfect state.



### Attention!

**Before inserting the plug, ensure that the voltage of the power supply line corresponds to that indicated on the vacuum cleaner's identification plate.**

- Make sure that the power plug is inserted properly into the socket and that the power cord is intact and in perfect condition.
- Make sure that the hose is inserted properly and tightened in the special suction nozzle (detail no. 4, chapter 1.1).
- Make sure that the dirt collection container (detail no. 6, chap. 1.1) is fitted and locked under the FILTER chamber (detail no. 3, chap. 1.1) of the vacuum cleaner
- Block the vacuum cleaner using the lever on the swivel casters, as shown in the figure.

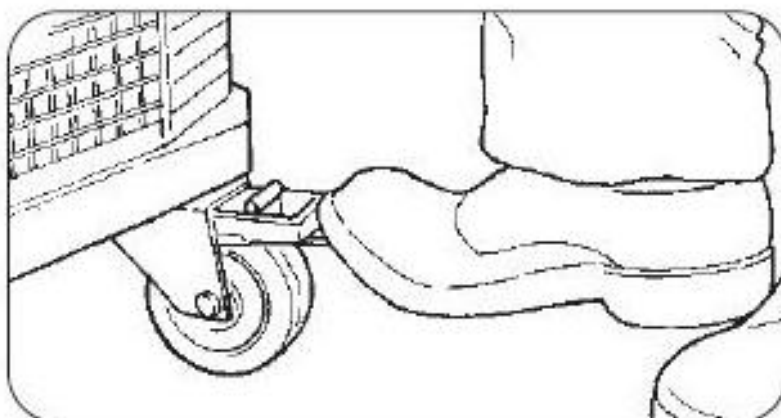



Hold the end of the hose with the chosen accessory.

To turn the vacuum cleaner on, turn the I/O (1) switch to "I", make sure that the white PRESENCE VOLTAGE indicator light (3) is on, and to start suction press the green START SUCTION button (6); while vacuuming, make sure that the green SUCTION IN PROGRESS light (7) is on, indicating that the pump is running.

To stop vacuuming press the red STOP SUCTION button (8).

If necessary, suction can be stopped immediately by pressing the red mushroom-head EMERGENCY STOP button (2).

The unexpected stop of the suction together with the activation of the yellow THERMAL CUT-OUT light (4) indicates that the pump has overheated, for causes and solutions see par 5.8 of this manual.

To switch the vacuum cleaner off completely, turn the I/O switch to "O".



**Attention!**

**Before turning the vacuum cleaner off, make sure that the green FILTER CLEANING IN PROGRESS light (5) (on models SP, PSC AND SE) is off, otherwise wait until the indicator light turns off. Do not switch the vacuum cleaner off while this light is on!**

Use the handles (detail no. 2, chap. 1.1) at the back of the machine to move the vacuum cleaner.



**Warning!**

**During operation, prevent the hose from rolling up or bending.**

There is a vacuum meter installed on the front of the vacuum cleaner to indicate the level of negative pressure inside the vacuum while it is in operation. The

vacuum gauge indicates the condition of the filter, with consequent reduction of the suction power.

When the filter is clogged, the vacuum meter indicates the value shown in the table below. In this case, stop vacuuming and shake the filter or clean the cartridges in the event of compressed air.

Model	Clogged filter value	
PUMA 10 / PUMA 12	-0.19 bar	-19 kPa
PUMA 15 S	-0.44 bar	-44 kPa
PUMA 15 P	-0.26 bar	-26 kPa
PUMA 18	-0.31 bar	-31 kPa

**Warning!**

Do not use the vacuum cleaner with the filter clogged

### 4.3 Cleaning the filter

To clean the filter in vacuum cleaners equipped with manual filter shaker, proceed as follows:

- Stop vacuuming by pressing the red STOP SUCTION button (8)
- act vigorously on the lever shown in the figure below

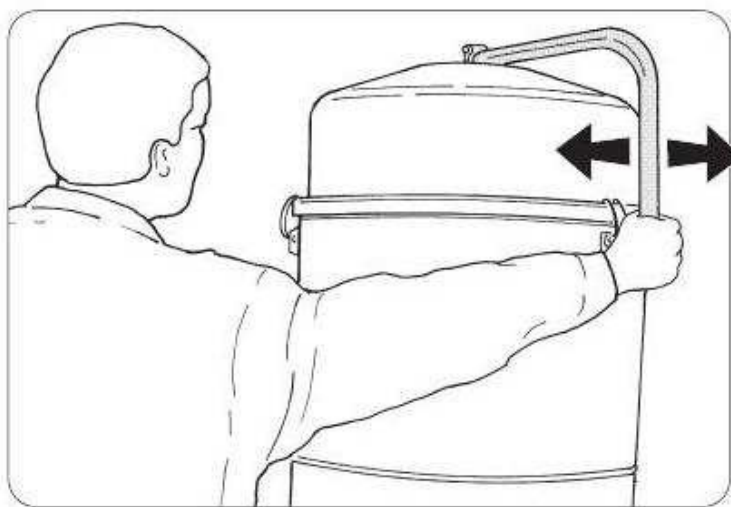

The vacuum cleaner with compressed air cartridge cleaning ("SP" models) (where applicable), as mentioned previously, must be connected to the compressed air line (see par. 3.3 of this manual. The filter cartridges are cleaned automatically during and after vacuuming. We recommend manually activating the cleaning system every 40 hours for further cleaning of the filter cartridges. In this case, proceed as follows:

- Interrompere l'aspirazione premendo il pulsante rosso (8) ARRESTO ASPIRAZIONE
- On the electrical panel, press the blue START FILTER MANUAL CLEANING button (9) and make sure that the green FILTER CLEANING IN PROGRESS light (5) is on
- wait about 5 minutes, making sure that the green FILTER CLEANING IN PROGRESS light has switched off. Otherwise wait for it to turn off
- resume vacuuming by pressing the green START SUCTION button (6)



In vacuum cleaners with electric filter shaker ("SE" models) or with pneumatic filter shaker ("PSC" models) (where applicable), the filter will be automatically cleaned at the end of the vacuuming process.



**Attention!**

If the vacuum cleaner is not working properly after the filter has been cleaned, the filter may be clogged and need replacing

#### 4.4 Emptying the refuse container



**Attention!**

Wear PPE (gloves, dust mask, goggles, etc...) during this operation

Depending on the type and quantity of material being vacuumed, it is necessary to check periodically the dirt container to avoid filling it excessively.

Proceed as follows to empty the container:

- Stop vacuuming and switch off the machine
- As mentioned previously, the vacuum cleaner can be locked using the brake positioned on the swivel casters
- Release the container by lifting the handle

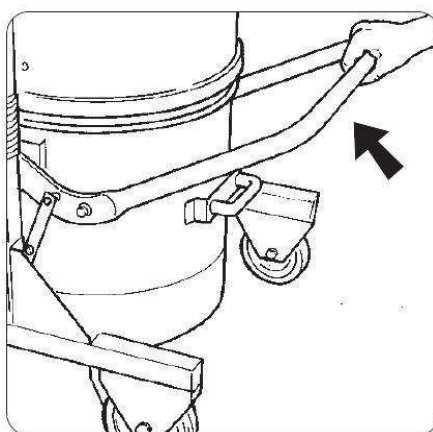



- Remove the container from the vacuum cleaner, using the handle on the container



**Attention!**

If the container weighs over 15 Kg, have somebody help you.



**Attention!**

Waste disposal must take place in compliance with the laws in force in the country in which the vacuum cleaner is used - for Italy Legislative Decree 152/2006 and subsequent amendments.

In the event of use with class M and H dusts, these must be conveyed to a special plastic bag

## 4.5 Inserting and locking the dirt container

Follow the steps below to insert and lock the container:

- Place the container under the vacuum, holding the lever raised, until it is fully against the stops. Make sure that the pins (A), present on both sides, are aligned with the slots of the container (B) as shown in the picture below

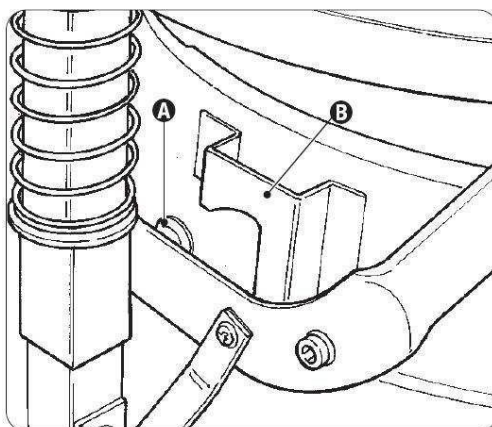



- push the container locking handle fully down with both hands

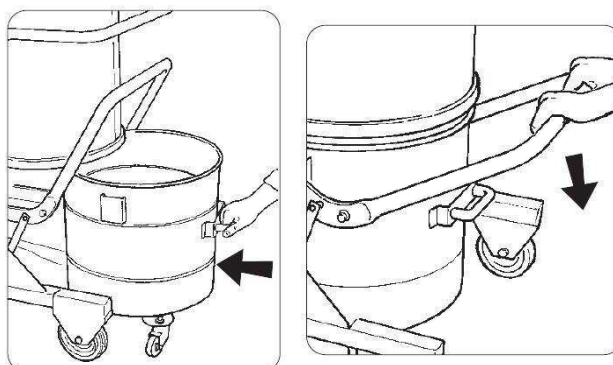

**Attention!**  
**Upper limb crushing hazard!**

**Do not, under any circumstance, place your hands between the container and the vacuum cleaner while locking it**

#### **4.6 Storage - decommissioning**

Remove the filter and clean it; empty the refuse collection container and store the vacuum in a place protected against weather agents with the temperature ranging between 0 and 40°C and cover it with a nylon sheet to protect it against dust

---

## 5. MAINTENANCE SECTION



### Warning!

Special vacuum maintenance must be carried out solely by specialised technicians authorised by the DEPURECO dealer.

### 5.1 Informative notes

This section describes the checks and routine maintenance operations required to ensure proper vacuum operation.

Maximum reliability and minimum maintenance costs are the result of a planned maintenance and inspection schedule carefully followed throughout the entire lifespan of the vacuum.

Observe the set maintenance intervals and schedule the interventions according to specific requirements in relation with the vacuum production cycle.

Always use perfectly working tools specifically intended for the operation to be carried out; the use of inadequate or inefficient tools can cause severe damages.

Any other intervention required to remove faults or malfunctions must be expressly authorised by the manufacturer.

In these cases, always communicate the vacuum identification data - see para. 1.4 of this manual.

For significant repairs, refer to the authorised dealer, whose specialised personnel has the technological expertise and is always available for prompt interventions.

For user maintenance operations, the vacuum must be disassembled, cleaned and maintained, where possible, in such a way as to prevent hazards to the maintenance personnel and to third parties. Suitable precautionary measures include decontamination before dismantling, measures for filtered forced ventilation of the room where the appliance is disassembled, cleaning of the maintenance area and suitable personal protection equipment.

Once every three months (or more frequently, according to the operating cycle and the conditions of use), the manufacturer or a qualified technician must check the filters, ensuring that they are not damaged; the tightness of the air system and proper operation of the control devices.

Should maintenance operations or repairs be carried out, all contaminated objects must be adequately cleaned, placed in waterproof bags and disposed of in compliance with the regulations in force.





## 5.2 General safety regulations



### Warning!

All the operations described above must be carried out with the plug disconnected from the socket.



Before starting any maintenance or cleaning operation, wear suitable PPE (protective clothing, goggles and/or gloves, etc.) according to the work to be done.

Place a sign on the vacuum with the message:

**“MACHINE UNDER MAINTENANCE  
DO NOT START”**



Before returning to use, the whole system must be checked according starting procedures.

Run a few trial operating cycles after every maintenance operation to ensure proper machine operation.

Failure to observe these precautions can cause serious injury to personnel.

Maintenance operations must be carried out by trained technicians specialised in the following sectors:

- Mechanical maintenance
- Electrical maintenance

It is the Safety Manager's duty to ensure the professionalism and skills of these technicians.

**Before starting any maintenance operation, the Safety Manager must:**

- Keep unauthorised personnel out of the work area.



- Ensure that the necessary tools are in good conditions and readily available to the maintenance technician.
- Ensure the maintenance technician is equipped with the personal protection equipment required for the specific operation (gloves, goggles, shoes, mask, etc.)
- Make sure the maintenance technician has carefully read the instructions contained in this manual and has perfectly acquired knowledge on the operation of the vacuum and its components.



- Ensure that there is enough light and, if necessary, provide 24 Volt torches.

**Before starting any maintenance operation, the Maintenance technician must:**

cut off all power supplies and set the vacuum cleaner in safety lock condition



**Warning!**

If absolutely necessary operating with the power turned on, pursuant to Italian Legislative Decree 81/08, the maintenance technician must maintain a safe distance, prepare reachable emergency stop buttons and never place hands in the discharge container.

At the end of the procedure and before returning to use, the maintenance technician must check that guards are functioning correctly and the protection devices are intact.

Operations on the motors or on other electrical components must only be carried out by the specially trained electrical maintenance technician authorised by the Safety Manager.



**Warning!**

After any maintenance intervention, the Health and Safety Manager is required to check the safety conditions of the vacuum cleaner and of its safety devices.

**Before every work shift**

- Check that the power cord and the plug are not damaged: replace them immediately if there are any signs of wear, using a cord of the same type (information c/o DEPURECO). This operation is the sole responsibility of an electrician.
- Check the integrity of the safety symbols (pictograms) applied to the vacuum cleaner.
- Verify the efficiency of the filters by checking the vacuum gauge.
- Check the integrity of the suction hose and of the accessories to be used.



**Warning!**

The flexible suction tube, if perforated, reduces the suction power and releases dust into the surrounding environment.



### 5.3 Replacing the filter



#### Warning!

Wear appropriate PPE (dust mask, latex gloves, goggles, etc.).

Proceed as follows to replace the filter:

- Switch the vacuum off by positioning the main switch to "O"
- Disconnect the vacuum cleaner from the power socket
- Disconnect the C.C.A. cleaning system (if provided) from the power supply (by switching of the related connector) and from the compressed air supply.
- Remove the container
- From the lower side of the filter chamber, release the clip and remove the retaining pin of the cage from the filter shaking lever

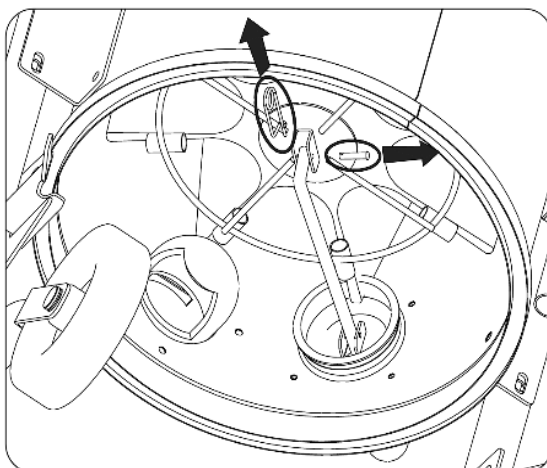

- Unlock from both sides the two locking hooks

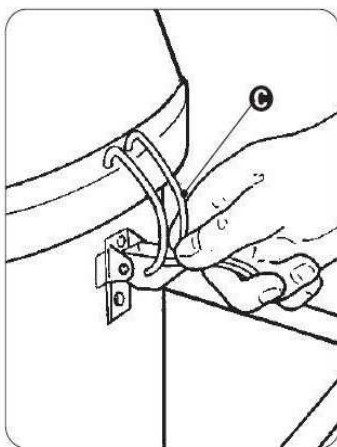



- Disconnect the suction pipe from the suction cap by loosening the strap
- Remove the cap
- Remove the H filter and/or the C.C.A cleaning system (if provided)
- Slip out the filter and place all components on a work bench
- Loosen the fastening clip (H), remove the filter from its support and, using scissors, cut the lower belts that clamp it to the shaking cage

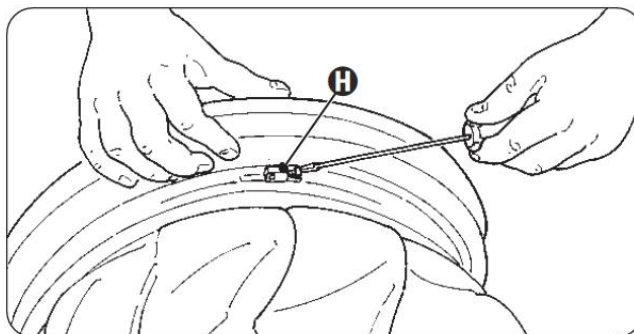

**Remove the filter, put it in a plastic bag, seal it and dispose it of according to the current legislation on the type of material extracted**

**To reassemble the filter,** operate in reverse order:

- Insert the new filter in the support ring and lock it by means of the fastening clip (H)
- lock the filter to the cage by tying the special laces on the bottom side
- insert the filter with ring and cage inside the filtering chamber, paying particular attention to align the cage to the filter shaking lever
- insert the lever end into the appropriate seat on the bottom of the cage and then insert the fastening clip
- place the H filter and/or the C.C.A cleaning system (if envisaged) on the filter top
- position the vacuum cleaner cup, insert the suction tube to the cap and tighten the fastening clip. Then lock the cap with the appropriate locking hooks
- Connect the C.C.A. cleaning system to the compressed air supply and to the power supply (by connecting the related connector)
- lock the dirt container under the filter chamber
- connect the vacuum cleaner to the mains
- turn on the vacuum cleaner, immediately assessing its efficient operation.



## 5.4 Replacing the filter cartridges on the C.C.A. cleaning system (if provided)

Follow the indications below to replace the filter cartridges of the C.C.A. cleaning system:

- Switch the vacuum off by positioning the main switch to "O"
- Disconnect the vacuum cleaner from the power socket
- Disconnect the C.C.A. cleaning system from the power (by disconnecting the related connector) and the compressed air mains
- Disconnect the suction pipe from the intake cap by loosening the fastening clip
- Remove the cap
- Unlock the locking hooks and raise up the vacuum cleaner cover
- Unlock and remove the H filter (if provided)
- Unlock the locking hooks of the C.C.A. cleaning system and pull it up along with another person from the filtering chamber, turn it over and place it on a work bench
- Remove and unscrew the fastening nuts from the cartridges base

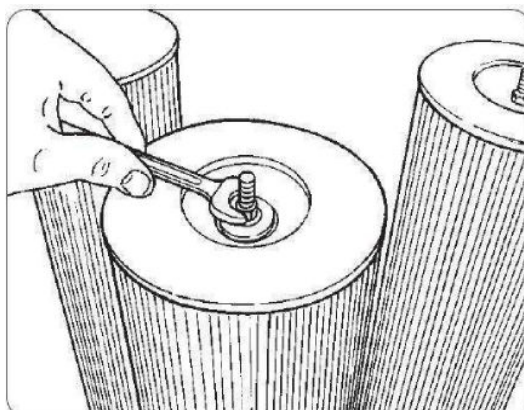

- Slip out and replace the filter cartridges



remove the filter, put it in a plastic bag, seal it and **dispose it of according to the applicable legislation on** the type of material collected.



---

Perform the same operations in reversed order **to fit back the filter cartridges:**

- Insert the new cartridges and tighten the fastening nuts, make sure they have been properly mounted
- Helped by a second person, place the C.C.A. on the filter chamber and lock it with the locking hooks
- position the H filter (if provided) and lock it by means of the locking hooks
- position the vacuum cleaner cup, insert the suction tube to the cap and tighten the fastening clip. Then lock the cap with the appropriate locking hooks
- Connect the C.C.A. cleaning system to the compressed air supply and to the power supply (by connecting the related connector)
- Connect the vacuum cleaner to the mains
- Switch the vacuum cleaner on by positioning the main switch to "I", then check to make sure it works properly.



## 5.5 Replacing the H filter (if provided)

To replace the HEPA cartridge proceed as follows:

- Switch the machine off by turning the main switch to “OFF”
- Unplug the vacuum
- Unlock the HEPA unit's three locking hooks (A) – The unit is positioned on the protecting cage of the vacuum cleaner's blower.
- Remove the cap (B)

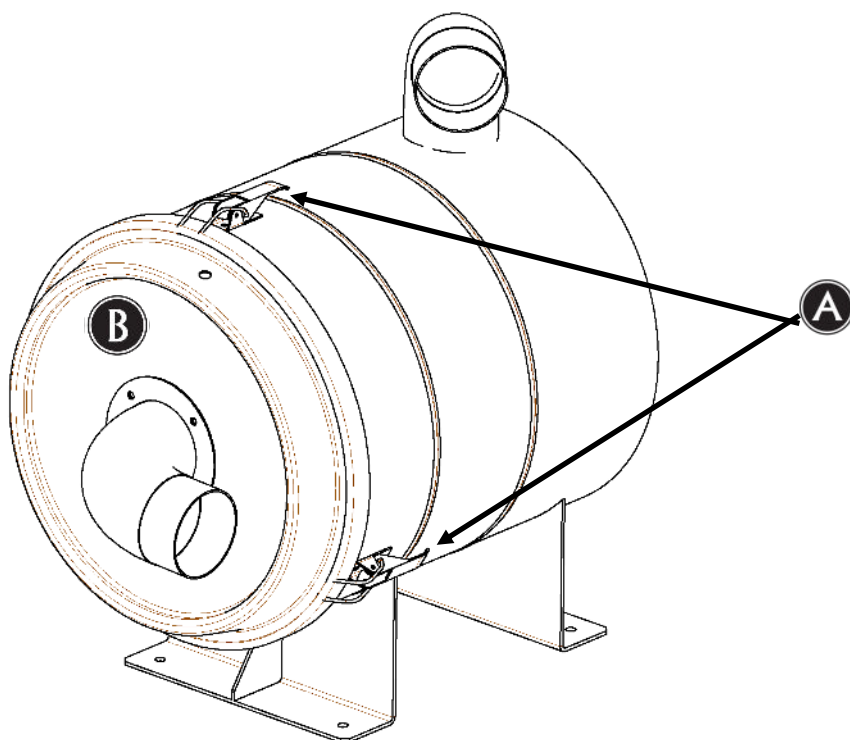

- Remove the HEPA cartridge by unscrewing the fastening nut.



remove the cartridge, put it in a plastic bag, seal it and **dispose it of according to the applicable legislation** on the type of material collected.



---

To reassemble the cartridge proceed in reverse order.

- Position the new cartridge inside the unit and secure the fastening nut again
- Reposition the unit's cap (**B**)
- Lock the unit's three locking hooks (**A**) and secure the HEPA unit
- Connect the vacuum cleaner to the mains
- Switch the vacuum cleaner on by positioning the main switch to "**ON**", then check to make sure it works properly.

**USE EXCLUSIVELY FILTERS MANUFACTURED BY DEPURECO**





## 5.6 Troubleshooting

FAULT DETECTED	POSSIBLE CAUSE	SOLUTION RECOMMENDED
The vacuum cleaner will not start	- No power supply Switch	<ul style="list-style-type: none"> <li>- Check for the presence of voltage in the socket</li> <li>- Check the condition of the plug and the power cable</li> <li>- Reset the magneto-thermal switch</li> <li>- Contact DEPURECO technical assistance</li> </ul>
	- circuit breaker tripped	
Irregular suction	- Clogged filters	- Clean any clogged filters. If this solution is not effective, replace it.
	- Clogged suction tube	- Check suction tube and clean it.
Excessive noise from motor	- Faulty pump	- Contact DEPURECO technical assistance



## 5.7 Scrapping



In case of scrapping, to avoid damage to the environment, all components of the vacuum cleaner, must be disposed of responsibly, in appropriate landfills, in compliance with current legislation - for Italy Legislative Decree no. 152/2006 and subsequent amendments. (subsequent modifications and additions).

Before scrapping the machine, the plastic and rubber materials must be separated from the electrical material.

Correct disposal of the product (electrical and electronic equipment waste)

The electrical and electronic parts of this product must be disposed of in compliance with Italian Legislative Decree 151/2005 and subsequent amendments. (Directive 2002/96/EC on WEEE - Waste Electrical and Electronic Equipment)

The parts of the vacuum made of plastic material, aluminium and steel can be recycled in appropriate centres.



**In the event of doubts, avoid interpreting the information! Call immediately your reseller!**



## MAINTENANCE LOG:

INTERVENTION 1:

DATE:

TECHNICAL ASSISTANCE:

TYPE OF INTERVENTION:

---

INTERVENTION 2:

DATE:

TECHNICAL ASSISTANCE:

TYPE OF INTERVENTION:

**INTERVENTION 3:**

**DATE:**

TECHNICAL ASSISTANCE:

TYPE OF INTERVENTION:

---

**INTERVENTION 4:**

**DATE:**

TECHNICAL ASSISTANCE:

TYPE OF INTERVENTION: